

EAST TALLULAH DRIVE  
WATER & SEWER IN ST R/W

RECORDED

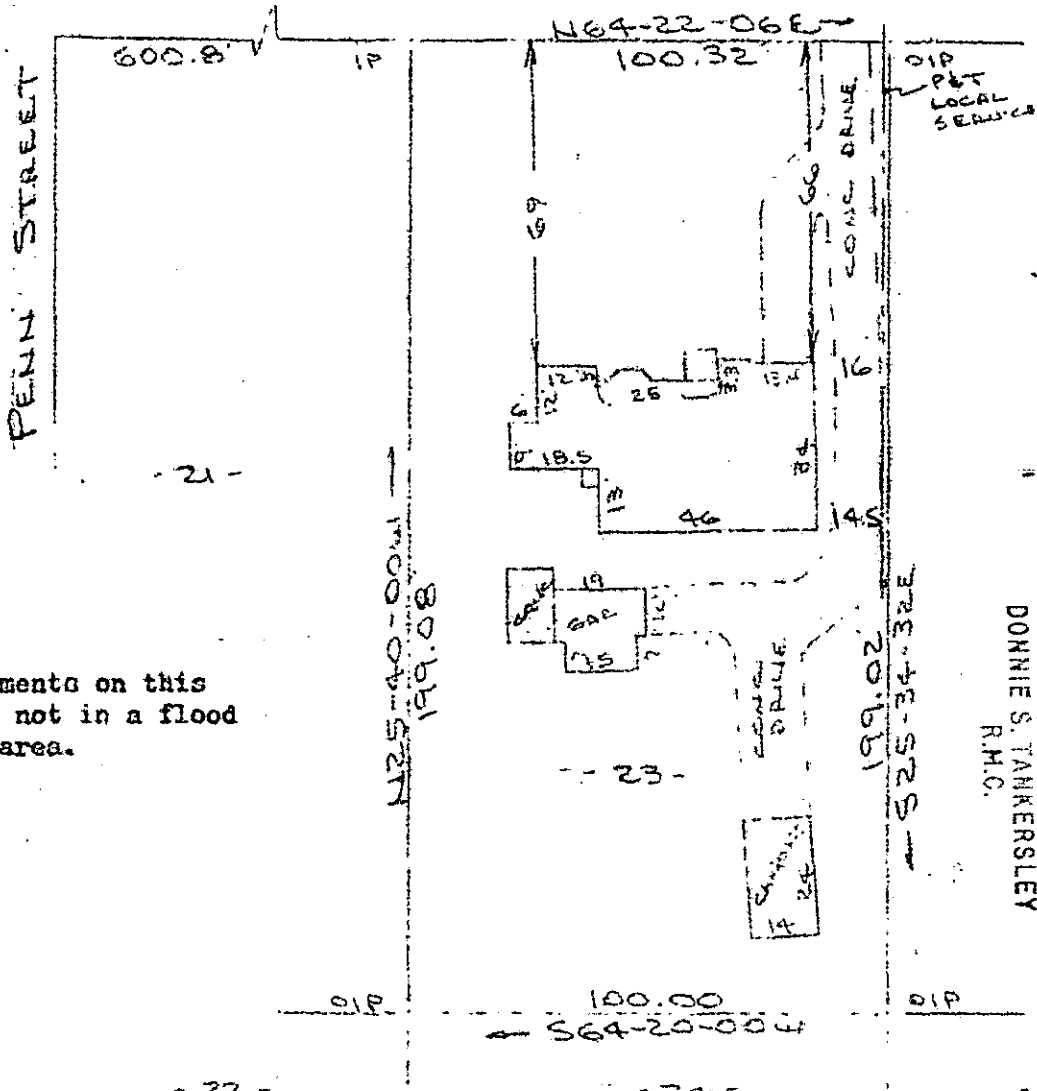

Note:  
Improvements on this  
lot are not in a flood  
hazard area.

FILED  
GREENVILLE CO. S.C.  
JUN 14 2 26 PM '84  
DONNIE S. TANKERSLEY  
R.M.C.

PROPERTY OF  
JAMES D. VEAZEY & CORNELIA VEAZEY  
GREENVILLE S.C.  
12 JUNE 1984

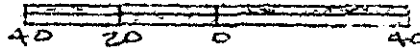

JUN 14 1984

10-5-2

This is to certify that on the 12th day of June, 1984, I surveyed the property shown on this plat, being known as lot 23 on plat of R. GLEN & HEATHER P. HILLIARD and recorded in the RMC Office Greenville County, S. C., in Plat Book " 9 - R " at Page 32; and that the property lines, walls and buildings are as shown hereon, and that the walls and buildings located on said lot do not encroach or project on adjacent street or property, and that no adjacent walls or buildings encroach or project on said premises, and no power lines cross this property except as shown hereon.

Recordable Plat

CAROLINA SURVEYING  
112 Manly  
Greenville, S. C.

R. B. Bruce, R.S. # 1952  
CO. St. C.  
CAROLINA REGISTERED SURVEYOR  
PRICE

ECTO -- 1 JUN 14 84 1224

3.0001